

# Valve

SUPERIOR QUALITY AND PLUMBING VERSATILITY

For easier and trouble-free installation



## Product Features

1. Made of durable ABS and PVC
2. Large handle for easy adjustment
3. Extremely reliable and maintenance free
4. Max. 4 bar working pressure
5. Able to withstand extreme chemical and temperature fluctuations
6. For 1.5"/50mm or 2"/63mm PVC pipe

**Pool & Spa Equipment**

 **Emaux**  
water technology

[www.emauxgroup.com](http://www.emauxgroup.com)

# Valve

## Check Valve

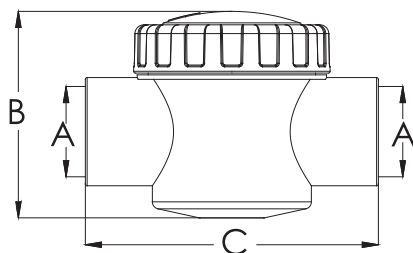
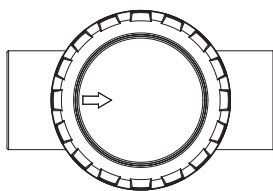

Code	Model	Material	Connection	A (mm)	B (mm)	C (mm)
88460301	V40-1(E)	ABS & PVC	50mm	Ø50	115	164
88460302	V50-1(E)	ABS & PVC	63mm	Ø63	129	190
88460311	V40-1(A)	ABS & PVC	1.5"	Ø48	115	164
88460312	V50-1(A)	ABS & PVC	2"	Ø60	129	190

## 2 Way Valve

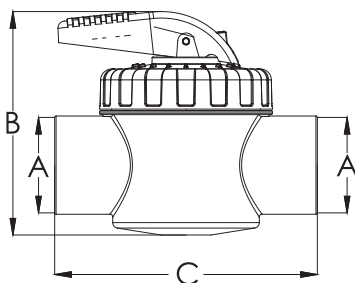
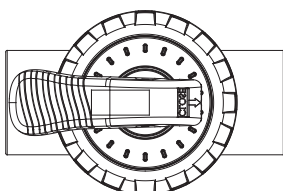

Code	Model	Material	Connection	A (mm)	B (mm)	C (mm)
88460101	V40-2(E)	ABS & PVC	50mm	Ø50	149	164
88460102	V50-2(E)	ABS & PVC	63mm	Ø63	161	190
88460111	V40-2(A)	ABS & PVC	1.5"	Ø48	149	164
88460112	V50-2(A)	ABS & PVC	2"	Ø60	161	190

## 3 Way Valve

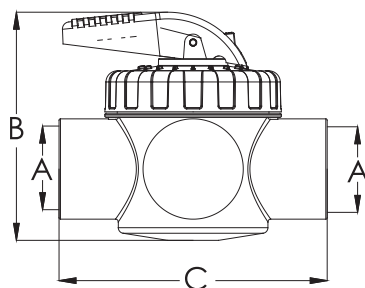
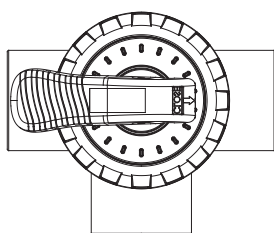

Code	Model	Material	Connection	A (mm)	B (mm)	C (mm)
88460201	V40-3(E)	ABS & PVC	50mm	Ø50	149	164
88460202	V50-3(E)	ABS & PVC	63mm	Ø63	161	190
88460211	V40-3(A)	ABS & PVC	1.5"	Ø48	149	164
88460212	V50-3(A)	ABS & PVC	2"	Ø60	161	190

### EMAUX WATER TECHNOLOGY CO., LTD

ADDRESS Flat A-D, 20/F., Kai Bo 22, 22 Wing Kin Road,  
Kwai Chung, Hong Kong

PHONE +852 2832 9880

www.emauxgroup.com

*Pool & Spa Equipment*

**YOUR PREMIER SUPPLIER**

Available from:

ALL SPECIFICATIONS ARE SUBJECT TO CHANGE WITHOUT NOTICE  
© 2021 EMAUX WATER TECHNOLOGY CO., LTD. ALL RIGHTS RESERVED.